



TIMBER MARKETING & MANAGEMENT INC.
 Professional Forestry Consultants
 P.O. Box 396
 Chesterfield, VA 23832
 Ph (804) 796-9622
 Fax (804) 796-9693
 www.tmmva.com

Sale Date:	March 28, 2019
Time:	11:00 a.m.
Day:	Thursday
Total Vol./Acre:	14,617 B. F.
Pine Vol/Tree:	96 B. F.
Hdwd. Vol/Tree:	308 B. F.

**CLEAR- CUT SALE
 EXCELLENT QUALITY HARDWOOD
 GREAT ACCESS**

Having been employed by **Terrill Ramsey** we solicit bids on all merchantable timber on **12 +/- acres** in **Charlotte County, Virginia** and as shown on the attached map.

We made a 5% plot cruise of the pulpwood trees to be harvested. Our estimate of their volume is:

<u>Pulpwood</u>	<u>Cords</u>	<u>Tons</u>
Pine	13	34
Soft Hardwood	29	75
Hard Hardwood	<u>32</u>	<u>83</u>
Total:	74	192

We have made a 100% count of the sawtimber-size trees to be harvested. Our estimate of their volume is:

<u>Sawtimber</u>			
Poplar	62,200	Beech	1,300
White Oak	59,000	Gum	1,100
Northern Red Oak	20,400	Maple	900
Red Oak	17,300	Shortleaf Pine	2,100
Hickory	4,100	Virginia Pine	<u>6,900</u>
Total:			175,300 BF Int 1/4" Scale

The above volumes are not guaranteed; however, care was taken in the field to assemble the above tables. You should note how your utilization practices may vary from the above and make any necessary adjustments.

Veneer

Included in the volumes are high quality trees that, from our review, will be of high enough quality that a veneer cut can be obtained. The veneer volume is estimated to be:

Red	128 BF Doyle Scale
White Oak	2,522 BF Doyle Scale

CONDITIONS

1. A period of time of 18 months will be allowed to cut and remove the timber.
2. Roads **must** be maintained and restored to their original condition upon completion of the logging. Any newly constructed roads and decks must be left in a graded condition and must be seeded upon completion of logging. Any newly constructed haul roads, skid roads and log decks and all logging operations must be in accordance with the guidelines set out in the **Best Management Practices Manual** of the Virginia Department of Forestry.
3. No tops or laps will be allowed to remain in the streams, fields, buffers or over cutting boundaries. They must be pulled back immediately.
4. Only the blue marked trees are to be cut from Streamside Management Zones.
5. No logging will be permitted during excessively wet weather conditions as determined by Timber Marketing & Management, Inc. If logging is halted due to weather conditions, then an extension of time equal to the time lost will be granted.
6. A \$2,000.00 performance bond will be paid at closing and held by Timber Marketing & Management, Inc. to insure compliance with all BMP requirements, road maintenance and conditions of the Timber Purchase Contract.

Only sealed bids will be accepted and owners reserve the right to reject any or all bids. BIDS SHOULD BE SUBMITTED PRIOR TO THE TIME OF BID OPENING AND CAN BE SUBMITTED VIA: Mail to: Timber Marketing & Management, Inc. P. O. Box 396, Chesterfield, Virginia 23832 **OR** hand delivered to 9520 Ironbridge Road, Chesterfield, Virginia **OR** telephoned in to 804-796-9622 **OR** faxed to 804-796-9693 **OR** emailed to tmm4u@aol.com Bids must be made on a lump-sum basis and must be received at this address no later than the posted bid date and time as shown on the cover. Closing shall take place within 30 days of bid acceptance.

There will be no scheduled show trip of the tract; however, you may call and set an appointment or you may inspect the property at your own leisure.

An electronic copy of this sale notice, including maps and volumes, is available for download and viewing on our website at www.tmmva.com under the Timber Sale Notices section.

Sincerely,
Timber Marketing & Management, Inc.

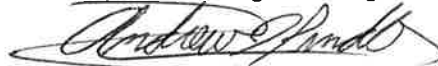

Andrew J. Lindberg, Area Manager
804-338-8436 mobile
804-796-9622 office

Ramsey Tract

Timber Marketing & Management, Inc.

Professional Forestry Consultants

P.O. Box 396

Chesterfield, VA 23832-0000

Phone: (804) 796-9622 • Fax: (804) 796-9693

Pulpwood Cruise: 5.0%
 Sawtimber Cruise: 100.0%
 Veneer Cruise: 100.0%

Cruise Date: Friday, February 22, 2019
 Owner's Name: Ramsey
 County/State: Charlotte County, VA
 Acreage: 12+/-
 Cruise Type: Tree Count
 Harvest Type: Clear Cut
 Total BF/Acre: 14,617
 Pine Vol/Tree: 96.1
 Hardwood Vol/Tree: 308.1

Volume Legend:

- 1) Diameters shown in inches (DBH)
- 2) Logs measured in 16' increments
- 3) Sawtimber volumes are shown in thousands of board feet (MBF)
- 4) Volume scale used for each species of sawtimber is noted
- 5) Pulpwood volumes are shown in standard cords (128 cubic feet)

Comments:

Pulpwood

Standard Cord

Wood Classification								
Pine			Soft Hardwood		Hard Hardwood		Cedar	
DBH	# Trees	Volume	# Trees	Volume	# Trees	Volume	# Trees	Volume
6			200	8	40	2		
8	40	4	120	9	100	8		
10	20	3	60	8	140	19		
12	20	5	20	4	20	4		
Total	80	13	400	29	300	32		

Beech - Sawtimber

International 1/4 Scale

Number of Logs								
DBH	1-Log	2-Log	3-Log	4-Log	5-Log	# Trees	Volume	% of Total
12	5					5	0.3	21.0%
14	4					4	0.3	24.9%
16	2					2	0.2	16.8%
20	1	1				2	0.5	37.2%
Total	12	1				13	1.3	

Gum - Sawtimber

International 1/4 Scale

Number of Logs								
DBH	1-Log	2-Log	3-Log	4-Log	5-Log	# Trees	Volume	% of Total
12	2					2	0.1	10.1%
16			1			1	0.3	23.1%
20		1	1			2	0.7	66.8%
Total	2	1	2			5	1.1	

Hickory - Sawtimber

International 1/4 Scale

Number of Logs								
DBH	1-Log	2-Log	3-Log	4-Log	5-Log	# Trees	Volume	% of Total
12	6					6	0.3	8.2%
14	2	2				4	0.4	11.0%
16	1	3				4	0.7	16.7%
18		2				2	0.5	12.2%
20		3				3	0.9	23.1%
22			1			1	0.5	13.0%
24			1			1	0.6	15.8%
Total	9	10	2			21	4.1	

Loblolly/Shortleaf Pine - Sawtimber

International 1/4 Scale

Number of Logs								
DBH	1-Log	2-Log	3-Log	4-Log	5-Log	# Trees	Volume	% of Total
10	4					4	0.1	6.8%
12		1	4			5	0.6	27.1%
14			2			2	0.4	17.6%
16			2			2	0.5	24.2%
20				1		1	0.5	24.2%
Total	4	1	8	1		14	2.1	

Maple - Sawtimber

International 1/4 Scale

Number of Logs								
DBH	1-Log	2-Log	3-Log	4-Log	5-Log	# Trees	Volume	% of Total
12	5					5	0.3	30.6%
14	2					2	0.2	18.1%
18		1				1	0.2	27.1%
22	1					1	0.2	24.2%
Total	8	1				9	0.9	

Northern Red Oak - Sawtimber

International 1/4 Scale

Number of Logs								
DBH	1-Log	2-Log	3-Log	4-Log	5-Log	# Trees	Volume	% of Total
12	1					1	0.1	0.3%
14	1					1	0.1	0.4%
16		3	1			4	0.8	4.1%
18	2	5	4			11	2.9	14.1%
20		1	5			6	2.4	12.0%
22		4	2			6	2.6	12.8%
24			8			8	5.2	25.3%
26			4			4	3.1	15.1%
28		1				1	0.7	3.2%
30			1			1	1.1	5.2%
36			1			1	1.6	7.7%
Total	4	14	26			44	20.4	

Ramsey Tract

Timber Marketing & Management, Inc.

Cruise Date: Friday, February 22, 2019
 Owner's Name: Ramsey
 County/State: Charlotte County, VA

Poplar - Sawtimber International 1/4 Scale

DBH	Number of Logs					# Trees	Volume	% of Total
	1-Log	2-Log	3-Log	4-Log	5-Log			
12	14					14	0.8	1.3%
14	5	18	1			24	3.1	5.0%
16	2	8	23	2		35	8.2	13.3%
18		2	15	3		20	6.7	10.8%
20		12	12	1		25	9.4	15.1%
22		5	15	5		25	13.0	21.0%
24		3	4	3		10	6.3	10.1%
26		3	6			9	6.3	10.1%
28		1	3			4	3.4	5.4%
30			2			2	2.1	3.4%
32			1			1	1.2	2.0%
36			1			1	1.6	2.5%
Total	21	52	83	14		170	62.2	

White Oak - Sawtimber International 1/4 Scale

DBH	Number of Logs					# Trees	Volume	% of Total
	1-Log	2-Log	3-Log	4-Log	5-Log			
12	24					24	1.3	2.3%
14	20	12				32	3.4	5.7%
16	8	24	5			37	6.7	11.4%
18	9	20	16	2		47	12.4	21.1%
20	1	14	14			29	10.6	17.9%
22	1	11	11	1		24	10.9	18.5%
24		9	4			13	6.8	11.5%
26		2	2			4	2.7	4.5%
28	1	2	2			5	3.5	5.9%
30		1				1	0.8	1.3%
Total	64	95	54	3		216	59.0	

Red Oak - Sawtimber International 1/4 Scale

DBH	Number of Logs					# Trees	Volume	% of Total
	1-Log	2-Log	3-Log	4-Log	5-Log			
12	6					6	0.3	1.9%
14	5	5				10	1.1	6.5%
16	2	7				9	1.6	9.0%
18	1	7	1			9	2.2	12.8%
20	2	4	4			10	3.3	19.2%
22	2	5	5			12	5.0	28.9%
24		1	1			2	1.1	6.4%
26		2	2			4	2.7	15.3%
Total	18	31	13			62	17.3	

Virginia Pine - Sawtimber International 1/4 Scale

DBH	Number of Logs					# Trees	Volume	% of Total
	1-Log	2-Log	3-Log	4-Log	5-Log			
10	30					30	1.1	15.6%
12	17	10				27	1.9	27.0%
14	4	7	3			14	1.9	27.1%
16	1	3	2			6	1.2	17.3%
18		1	1			2	0.6	8.4%
20		1				1	0.3	4.5%
Total	52	22	6			80	6.9	

Ramsey Tract

Timber Marketing & Management, Inc.

Cruise Date: Friday, February 22, 2019
 Owner's Name: Ramsey
 County/State: Charlotte County, VA

Sawtimber Volume by Timber Type

Timber Type	# Trees	Volume	Avg BF/Tree	% of Total
Hardwood	540	166.4	308.1	94.9%
Pine	94	9.0	96.1	5.1%
Total	634	175.4	276.7	

Sawtimber Volume by DBH

DBH	# Trees	Volume	Avg BF/Tree	% of Total
10	34	1.2	36.0	0.7%
12	95	6.0	62.9	3.4%
14	93	10.9	117.1	6.2%
16	100	20.2	202.3	11.5%
18	92	25.6	278.2	14.6%
20	79	28.7	363.8	16.4%
22	69	32.3	468.7	18.4%
24	34	20.0	588.5	11.4%
26	21	14.6	697.3	8.3%
28	10	7.5	750.3	4.3%
30	4	3.9	977.0	2.2%
32	1	1.2	1,213.0	0.7%
36	2	3.1	1,571.0	1.8%
Total	634	175.4	276.7	

Sawtimber Volume by Species

Species	# Trees	Volume	Avg BF/Tree	% of Total
Beech	13	1.3	102.4	0.8%
Gum	5	1.1	221.8	0.6%
Hickory	21	4.1	194.1	2.3%
Loblolly/Shortleaf Pine	14	2.1	150.9	1.2%
Maple	9	0.9	101.7	0.5%
Northern Red Oak	44	20.4	463.3	11.6%
Poplar	170	62.2	365.8	35.5%
Red Oak	62	17.3	279.5	9.9%
Virginia Pine	80	6.9	86.5	3.9%
White Oak	216	59.0	273.3	33.7%
Total	634	175.4	276.7	

Red Oak - Veneer

Doyle (Butt Log Scale)

DBH	Butt Log Length								# Logs	Volume	% of Total
	8'	10'	12'	14'	16'	18'	20'	22'			
22			1						1	128	100.0%
Total			1						1	128	

White Oak - Veneer

Doyle (Butt Log Scale)

DBH	Butt Log Length								# Logs	Volume	% of Total
	8'	10'	12'	14'	16'	18'	20'	22'			
18		1							1	58	2.3%
20			2						2	214	8.5%
22	2		2		2				6	846	33.5%
24		2			1				3	551	21.8%
26					1				1	282	11.2%
28		1			1				2	571	22.6%
Total	2	4	4		5				15	2,522	

Veneer Tag List

Tag	Species	DBH	Butt Log Length
A1	White Oak	26	16'
A2	Red Oak	22	12'
A3	White Oak	20	12'
A4	White Oak	18	10'
A5	White Oak	24	16'
A6	White Oak	22	12'
A7	White Oak	22	16'
A8	White Oak	28	16'
M1	White Oak	22	16'
M2	White Oak	22	8'
M3	White Oak	24	10'
M4	White Oak	28	10'
M5	White Oak	20	12'
M6	White Oak	22	12'
S1	White Oak	22	8'
S2	White Oak	24	10'

Veneer Volume by DBH

DBH	# Trees	Volume	Avg BF/Log	% of Total
18	1	58	58.0	2.2%
20	2	214	107.0	8.1%
22	7	974	139.1	36.8%
24	3	551	183.7	20.8%
26	1	282	282.0	10.6%
28	2	571	285.5	21.5%
Total	16	2,650	165.6	

Veneer Volume by Species

Species	# Trees	Volume	Avg BF/Log	% of Total
Red Oak	1	128	128.0	4.8%
White Oak	15	2,522	168.1	95.2%

RAMSEY TRACT
Charlotte County, VA

SMZ Along Boundary Line
Only Cut Blue Marked Trees

Clear-Cut Area
Outlined in Yellow
12 +/- Acres

No-Cut Buffer
Along Parking Lot.
Flagged in Pink

Access from Rt. 40

Property Boundaries
Flagged in Orange

TIMBER MARKETING & MANAGEMENT INC.
Professional Forestry Consultants
P.O. Box 396
Chesterfield, VA 23832
Ph (804) 796-9622
Fax (804) 796-9693
www.tmmva.com



Declination
★
MN
MN 9.52° W



Name: RAMSEY TRACT
Date: 03/04/19
Scale: 1 inch = 376 ft.

Location: 037° 03' 23.4620" N, 078° 39' 19.9942" W
12 +/- Acre Clear-Cut

(C) Copyright 2017, Mapbox

RAMSEY TRACT
Charlotte County, VA

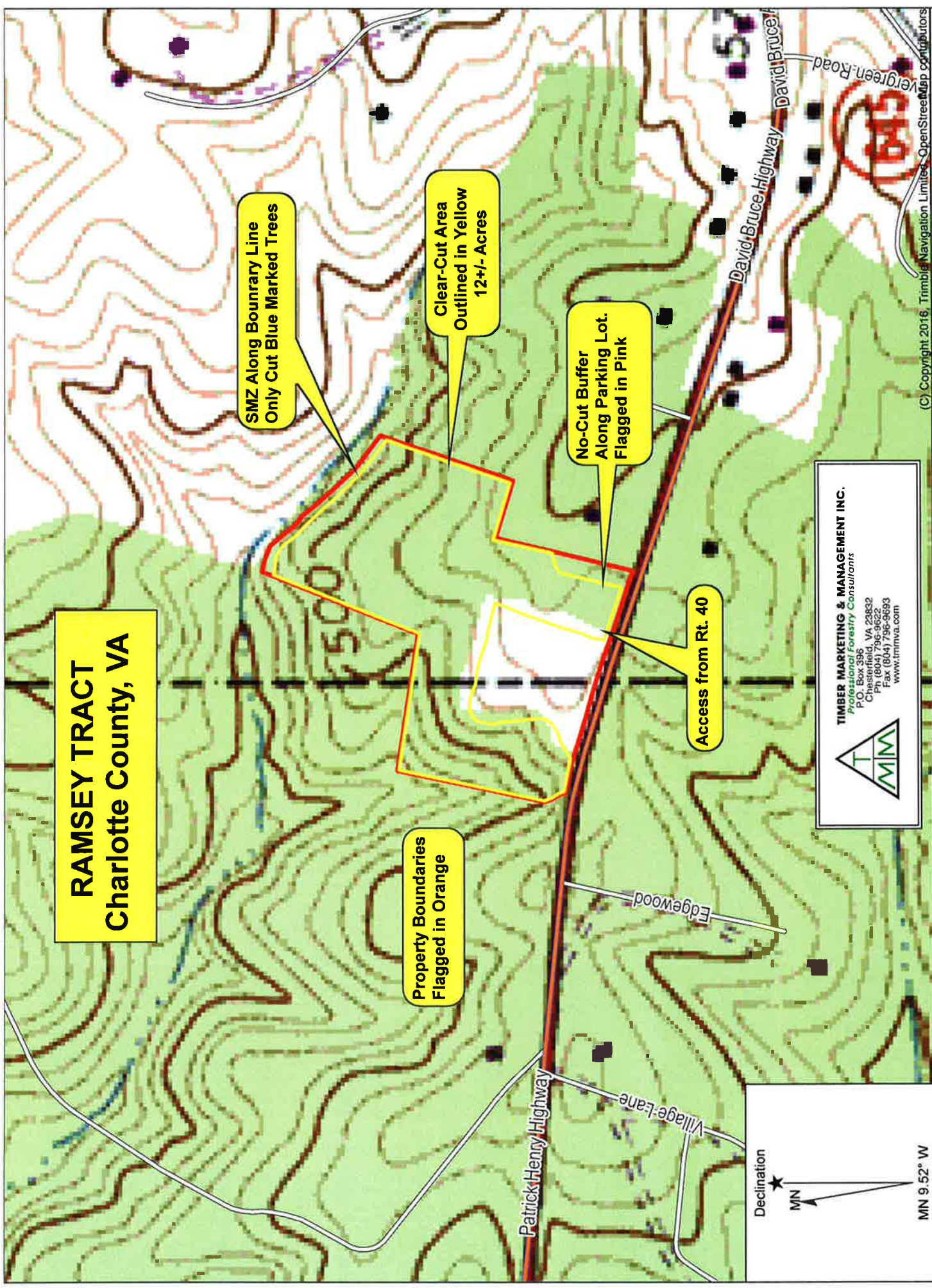

SMZ Along Boundary Line
Only Cut Blue Marked Trees

Clear-Cut Area
Outlined in Yellow
12 +/- Acres

No-Cut Buffer
Along Parking Lot.
Flagged in Pink

Access from Rt. 40

Property Boundaries
Flagged in Orange

TIMBER MARKETING & MANAGEMENT INC.
Professional Forestry Consultants
P.O. Box 396
Charlottesville, VA 22902
Phone (804) 796-9693
www.tmmva.com



Declination
MN
MN 9.52° W

Name: RAMSEY TRACT
Date: 03/04/19
Scale: 1 inch = 376 ft.

Location: 037° 03' 23.8577" N, 078° 39' 19.7463" W
12 +/- Acre Clear-Cut

(C) Copyright 2016, Trimble Navigation Limited

RAMSEY TRACT Charlotte County, VA

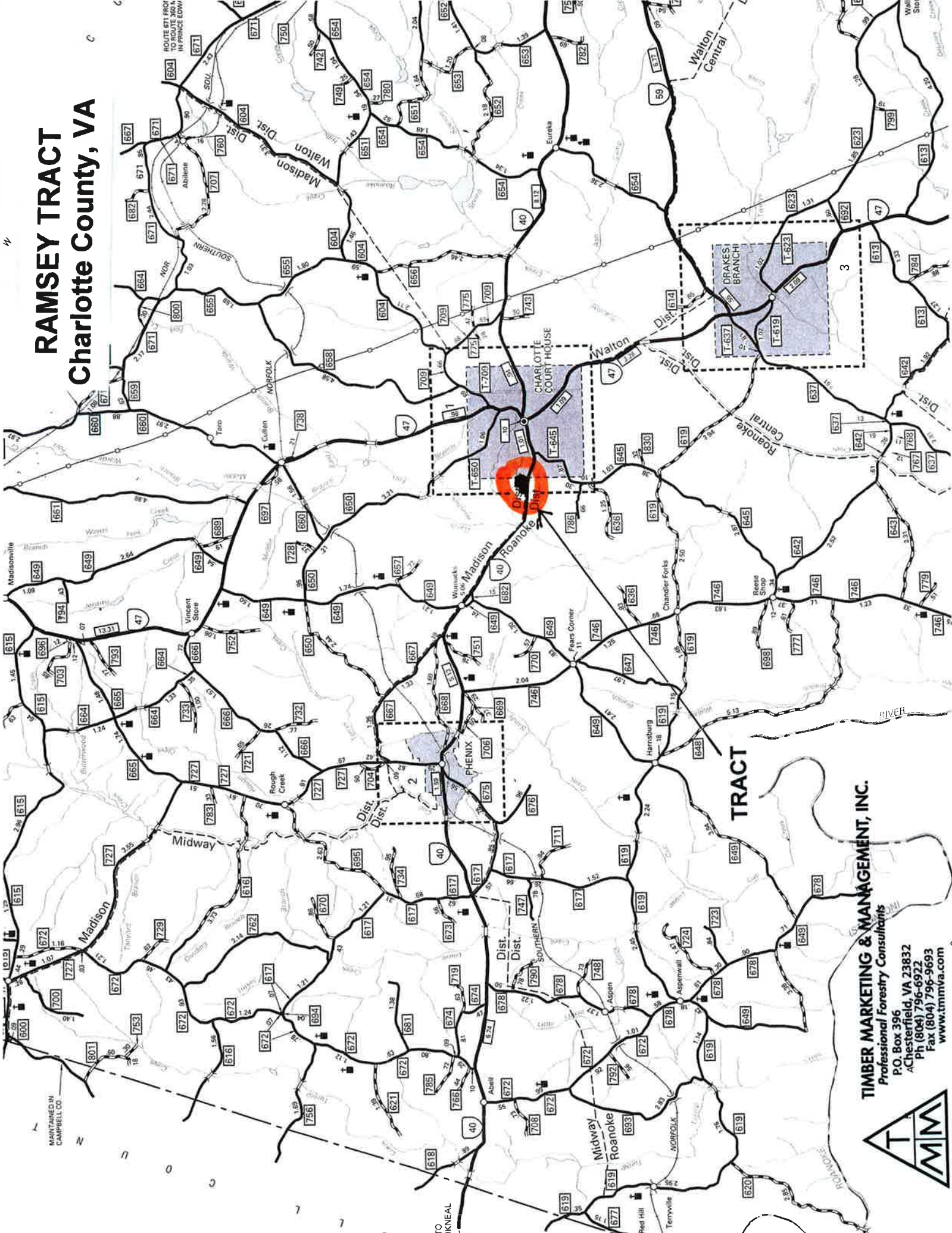

TRACT

TIMBER MARKETING & MANAGEMENT, INC.
Professional Forestry Consultants

P.O. Box 396
A Chesterfield, VA 23832
Ph (804) 796-6922
Fax (804) 796-9693
www.tmmva.com



MAINTAINED IN
CAMPBELL CO